



## Features/Benefits

- Compact design
- Low actuation force
- Detect mechanical movement
- Left and right options
- Right angle options

## Typical Applications

- Computer peripherals
- Office equipment
- Consumer electronics
- Appliances
- Audio and visual equipment

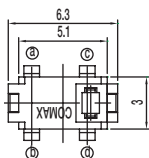

| PART NUMBER     | PACKAGING    | SCHEMATIC |
|-----------------|--------------|-----------|
| <b>DS-02005</b> | 1,000 pieces | 1P-1T     |

## Specifications

CONTACT ARRANGEMENT: SPST, NO  
 CONTACT RATING: 100mA @ 30 VDC  
 OPERATING LIFE: 50,000 cycles  
 OPERATING FORCE: 50 gf max.  
 PRE-TRAVEL: 0.7 mm  
 TOTAL TRAVEL: 2.6 mm  
 INITIAL CONTACT RESISTANCE: 1  $\Omega$  max.  
 INSULATION RESISTANCE: 100 M  $\Omega$  min. @ 100 VDC 60 sec.  
 DIELECTRIC STRENGTH: 100 V AC (50-60Hz) 60 sec.  
 OPERATING TEMPERATURE: -40°C to +85°C.

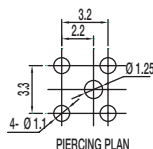
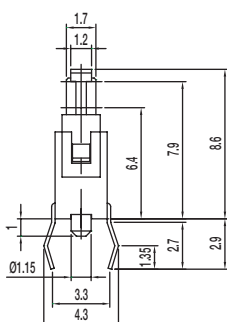
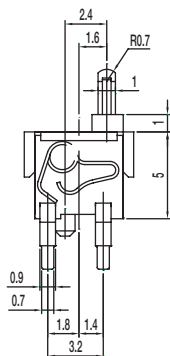

## Materials

KNOB: PA  
 COVER: PA  
 SPRING: Gold plated, copper alloy  
 HOUSING: PA  
 TERMINAL: Silver plated, copper alloy

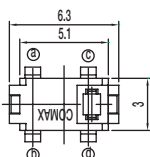

| PART NUMBER          | PACKAGING    | SCHEMATIC |
|----------------------|--------------|-----------|
| <b>DS-02005 (30)</b> | 1,000 pieces | 1P-1T     |

## Specifications

CONTACT ARRANGEMENT: SPST, NO  
 CONTACT RATING: 100mA @ 30 VDC  
 OPERATING LIFE: 50,000 cycles  
 OPERATING FORCE: 30 gf max.  
 PRE-TRAVEL: 0.7 mm  
 TOTAL TRAVEL: 2.2 mm  
 INITIAL CONTACT RESISTANCE: 1  $\Omega$  max.  
 INSULATION RESISTANCE: 100 M  $\Omega$  min. @ 100 VDC 60 sec.  
 DIELECTRIC STRENGTH: 100 V AC (50-60Hz) 60 sec.  
 OPERATING TEMPERATURE: -40°C to +85°C.

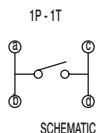
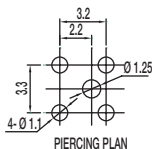
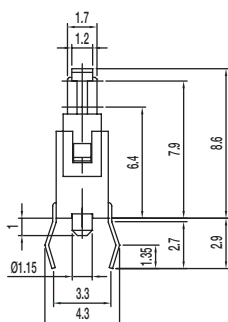
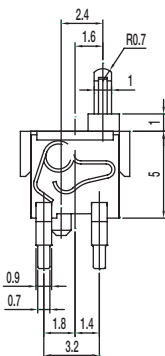

## Materials

KNOB: PA  
 COVER: PA  
 SPRING: Gold plated, copper alloy  
 HOUSING: PA  
 TERMINAL: Silver plated, copper alloy



Detect



Detect

# DS Series Detect Switch

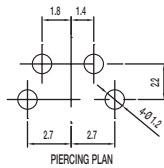
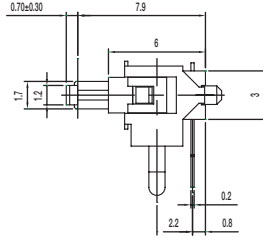
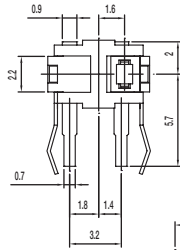
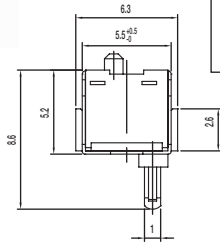

| PART NUMBER       | PACKAGING    | SCHEMATIC         |
|-------------------|--------------|-------------------|
| <b>DS-02005-A</b> | 1,000 pieces | 1P-1T<br><br>N.O. |

## Specifications

CONTACT ARRANGEMENT: SPST, NO  
 CONTACT RATING: 100mA @ 30 VDC  
 OPERATING LIFE: 50,000 cycles  
 OPERATING FORCE: 50 gf max.  
 PRE-TRAVEL: 0.7 mm  
 TOTAL TRAVEL: 2.6 mm  
 INITIAL CONTACT RESISTANCE: 1  $\Omega$  max.  
 INSULATION RESISTANCE: 100 M  $\Omega$  min. @ 100 VDC 60 sec.  
 DIELECTRIC STRENGTH: 100 V AC (50-60Hz) 60 sec.  
 OPERATING TEMPERATURE: -40°C to +85°C.

## Materials

KNOB: PA  
 COVER: PA  
 SPRING: Gold plated, copper alloy  
 HOUSING: PA  
 TERMINAL: Silver plated, copper alloy

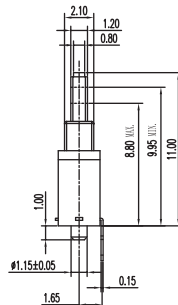
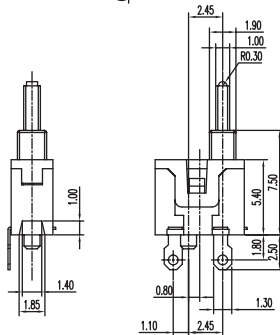
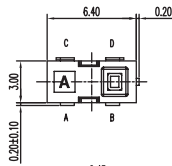

| PART NUMBER     | PACKAGING    | SCHEMATIC |
|-----------------|--------------|-----------|
| <b>DS-21805</b> | 2,500 pieces | <br>N.O.  |

## Specifications

CONTACT ARRANGEMENT: SPDT  
 CONTACT RATING: 5mA @ 5 VDC  
 OPERATING LIFE: 100,000 cycles  
 OPERATING FORCE: 36 gf  
 TOTAL TRAVEL: 2.20 mm  
 INITIAL CONTACT RESISTANCE: 1  $\Omega$  max.  
 INSULATION RESISTANCE: 100 M  $\Omega$  min. @ 100 VDC 60 sec.  
 DIELECTRIC STRENGTH: 100 V AC (50-60Hz) 60 sec.  
 OPERATING TEMPERATURE: -20°C to +70°C.

## Materials

KNOB: POM  
 COVER: PA46  
 SPRING: Silver plated  
 HOUSING: PPS  
 TERMINAL: Silver plated

Detect



Detect







| PART NUMBER           | PACKAGING  | SCHEMATIC   |
|-----------------------|------------|---|
| <b>DS-09005-02 BK</b> | 500 pieces | <br>N.O. |

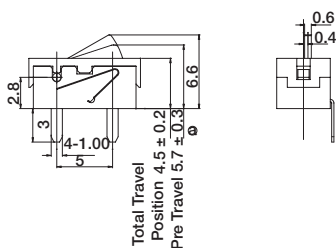
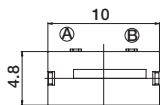

## Specifications

CONTACT ARRANGEMENT: SPST  
 CONTACT RATING: 1mA @ 5 VDC  
 OPERATING LIFE: 100,000 cycles  
 OPERATING FORCE: 50 gf max.  
 TOTAL TRAVEL: 4.5±0.2 mm  
 INITIAL CONTACT RESISTANCE: 500 m Ω max.  
 INSULATION RESISTANCE: 100 M Ω min. @ 500 VDC 60 sec.  
 DIELECTRIC STRENGTH: 500 V AC (50-60Hz) 60 sec.  
 OPERATING TEMPERATURE: -20°C to +70°C.

## Materials

LEVER: POM  
 COVER: PA  
 HOUSING: PA  
 TERMINAL: Silver plated

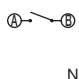

| PART NUMBER           | PACKAGING  | SCHEMATIC   |
|-----------------------|------------|---|
| <b>DS-09005-02 RP</b> | 500 pieces | <br>N.O. |

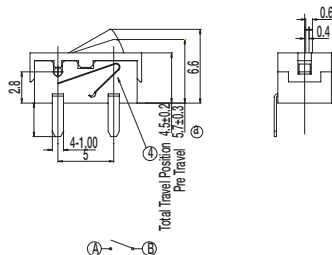
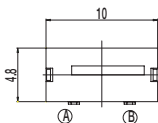

## Specifications

CONTACT ARRANGEMENT: SPST  
 CONTACT RATING: 1mA @ 5 VDC  
 OPERATING LIFE: 100,000 cycles  
 OPERATING FORCE: 50 gf max.  
 TOTAL TRAVEL: 4.5±0.2 mm  
 INITIAL CONTACT RESISTANCE: 500 m Ω max.  
 INSULATION RESISTANCE: 100 M Ω min. @ 500 VDC 60 sec.  
 DIELECTRIC STRENGTH: 500 V AC (50-60Hz) 60 sec.  
 OPERATING TEMPERATURE: -20°C to +70°C.

## Materials

LEVER: POM  
 COVER: PA  
 HOUSING: PA  
 TERMINAL: Silver plated



Detect